

VIEWPORT 1
SCALE - 1:250m

A1

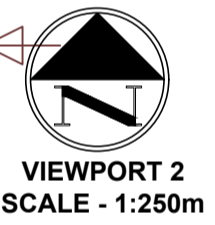

VIEWPORT 2
SCALE - 1:250m

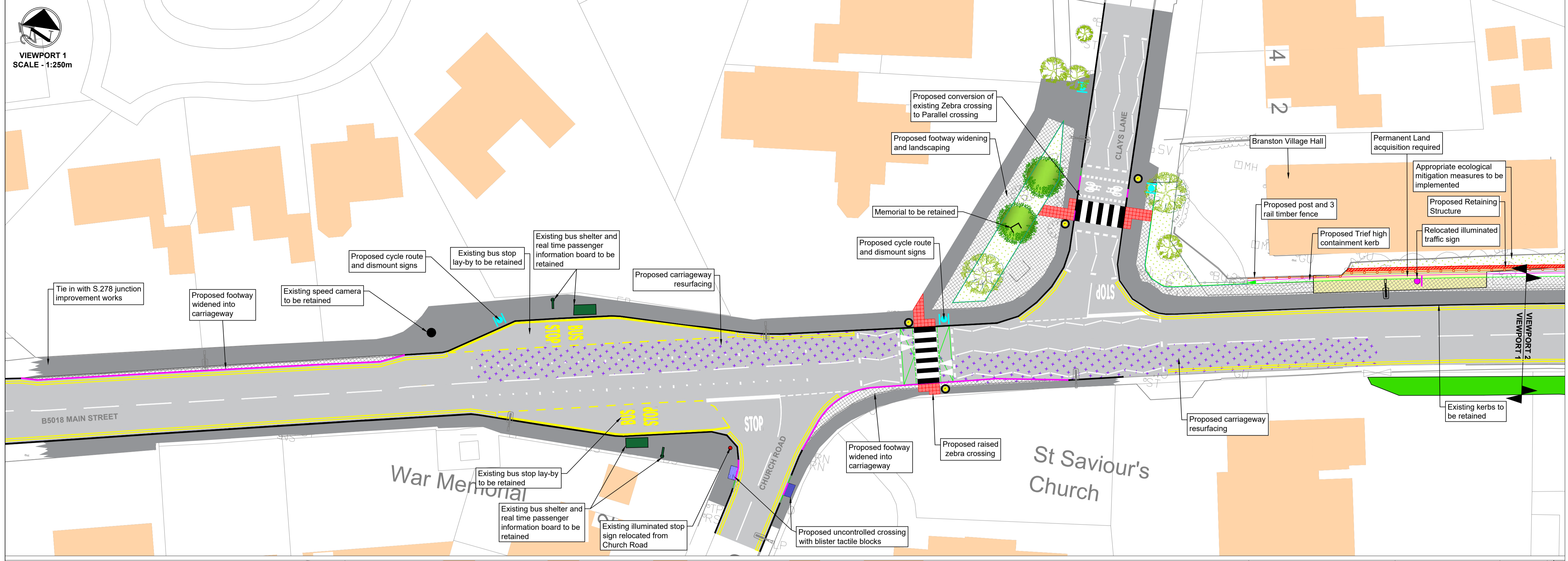
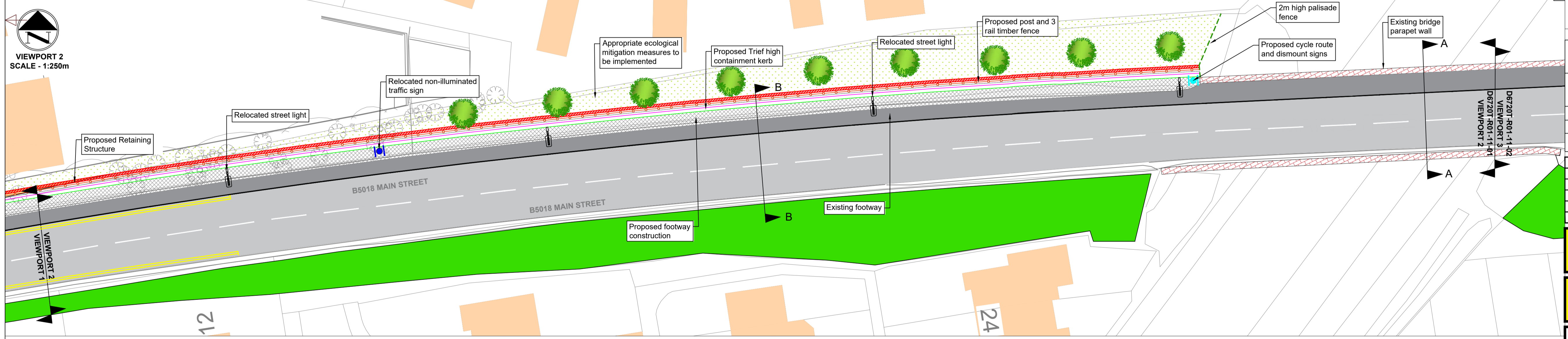

KEY:

- Existing footway
- Existing carriageway
- Proposed footway
- Existing kerb
- Proposed kerb amendments
- Proposed PCC edging
- Proposed Trief kerb
- Repositioned street lighting
- Existing street lighting
- Proposed pedestrian guard rail
- Proposed fence line
- Proposed 2m high palisade fencing
- Proposed belisha beacon
- Proposed tactile paving
- Proposed blister paving
- Proposed carriageway resurfacing
- Repositioned illuminated sign
- Repositioned non-illuminated sign
- Proposed cycle route and dismount sign
- Proposed illuminated sign
- Proposed Retaining Structure
- Area of Land Require Permanent Acquisition
- Proposed Landscape
- New Trees
- Existing Trees Retained

Rev	Detail	By	Date
R2	Revised the design to keep the bus lay-by and moved the position of zebra crossing	MM	05/11/2023
R1	Removed one way proposal on Church Road; as a result, the crossing design and bus stop designs were changed on B5018 Main Street.	MM	01/11/2023
R0	Original Drawing	MM	04/09/2023

Revisions

Original Version	Preliminary
Drawn: MM	For target cost
Design: MM	For tender
Date: Sept 2023	For construction
	As constructed
	For information

Checked by: _____

Approved by: (Drawing NOT approved if this box is empty)

Staffordshire County Council
working with Amey

www.staffordshire.gov.uk | www.amey.co.uk

Project Name
**B5018 Main Street Branstons
Cycleway & Footway
Improvements**

Drawing Title
**AMEY CONSULTING
Consultation - Sheet 1 of 2**

Grid reference : 422706.321219	Original Drawing Size : A1	Dimensions : m
Scale : As Shown	Copyright © Amey	

Drawing No D6720T-R01-11-01	Rev R2
---------------------------------------	------------------

File Name: J:\Highways\Integrated Transport\B6720T - Burton - Land South of Branstons\3 CAD\Disciplines\1. WIP\1 Live Drgs\Outline\D6720T-R01-11 - Consultation.dwg
Layout Name: 01

